

# Cappa a parete inox aisi 304

## MODELLO SNACK

*Snack wall extractor hood*

Con motore *With engine*

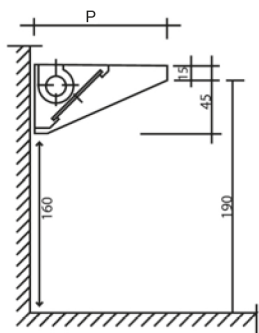

CODICE	DIMENSIONI			PORTATA	FILTRI	TIPO MOTORE		
	P	L	H			NUMERO	V240	
<b>RBM7-10</b>	70	100	45	20X25	1.450	2	40X40	7/7
<b>RBM7-12</b>	70	120	45	20X25	1.650	2	40X40	7/7
<b>RBM7-14</b>	70	140	45	20X25	1.900	3	40X40	7/7
<b>RBM7-16</b>	70	160	45	20X25	2.200	3	40X40	7/7
<b>RBM7-18</b>	70	180	45	20X25	2.450	4	40X40	7/7
<b>RBM7-20</b>	70	200	45	20X25	2.750	4	40X40	7/7
<b>RBM7-22</b>	70	220	45	20X25	3.050	4	40X40	8/9
<b>RBM7-24</b>	70	240	45	20X25	3.300	5	40X40	8/9
<b>RBM9-10</b>	90	100	45	20X25	1.600	2	40X50	7/7
<b>RBM9-12</b>	90	120	45	20X25	1.900	2	40X50	7/7
<b>RBM9-14</b>	90	140	45	20X25	2.250	3	40X50	7/7
<b>RBM9-16</b>	90	160	45	20X25	2.550	3	40X50	7/7
<b>RBM9-18</b>	90	180	45	20X25	2.900	4	40X50	8/9
<b>RBM9-20</b>	90	200	45	20X25	3.200	4	40X50	8/9
<b>RBM9-22</b>	90	220	45	20X25	3.550	4	40X50	8/9
<b>RBM11-10</b>	110	100	45	20X25	1.750	2	40X50	7/7
<b>RBM11-12</b>	110	120	45	20X25	2.100	2	40X50	7/7
<b>RBM11-14</b>	110	140	45	20X25	2.490	3	40X50	7/7
<b>RBM11-16</b>	110	160	45	20X25	2.850	3	40X50	7/7
<b>RBM11-18</b>	110	180	45	20X25	3.200	4	40X50	8/9
<b>RBM11-20</b>	110	200	45	20X25	3.550	4	40X50	8/9

Collarino Ø 200-350

Illuminazione per cappa 18w=L=68

Illuminazione per cappa 58w=L=156

Collarino a tramoqgia Ø 200-350

Illuminazione per cappa

Illuminazione con faretti a led  
170,00 ml